

MAGICOR

Premium Wall Panel

Wall Panel Application User Guide

- Please read the guide carefully before start application.
- The panel should be checked if there is any damage on it.
- Application should follow local construction or fire regulation.
- Please follow application standard and our remark in order to avoid contraction and expansion of the panel by environment.
- Protection film is attached on the face of the panel.

Safety Precautions

- When processing the substrate, follow application guide from substrate manufacturer.
- Residential gas range should be away from the panel, more than 150mm.
- The panel is not available around commercial gas range.
- During moving and applying, wear anti-slip gloves, protection mask and protection glasses. Cutter should be dust-proof. Keep your environment ventilated.
- Wash with water immediately, if dust hits your skin, eyes, nose or mouth.
- Be careful of cut edges in case of damage your fingers.

Application process

Substrate check (Primer application) ➡ Panel Layout ➡ Cutting and processing ➡
Double-sided tape application ➡ Adhesive application ➡ Panel Application ➡ Protection film removal
(Adhesive should be cured for 2 days after panel application.)

Construction method

1 Substrate check

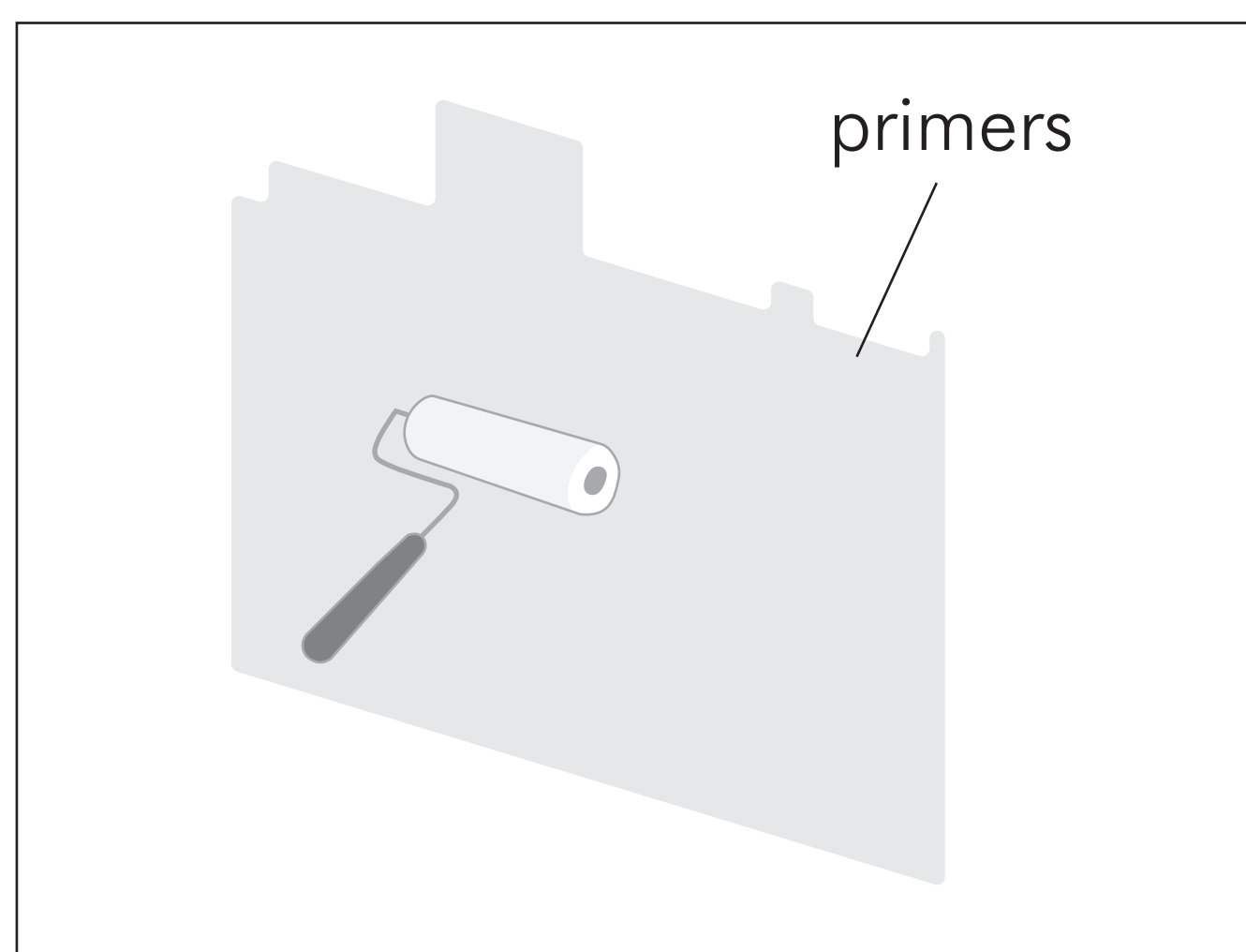

Apply primer on substrate in advance if substrate is concrete, plywood or gypsum board. Ensure that substrate is flat and cleansed with cleaning agent.

Recommended primer:
Similar primers to
3M UPUV PRIMER 946ml

2 Panel layout

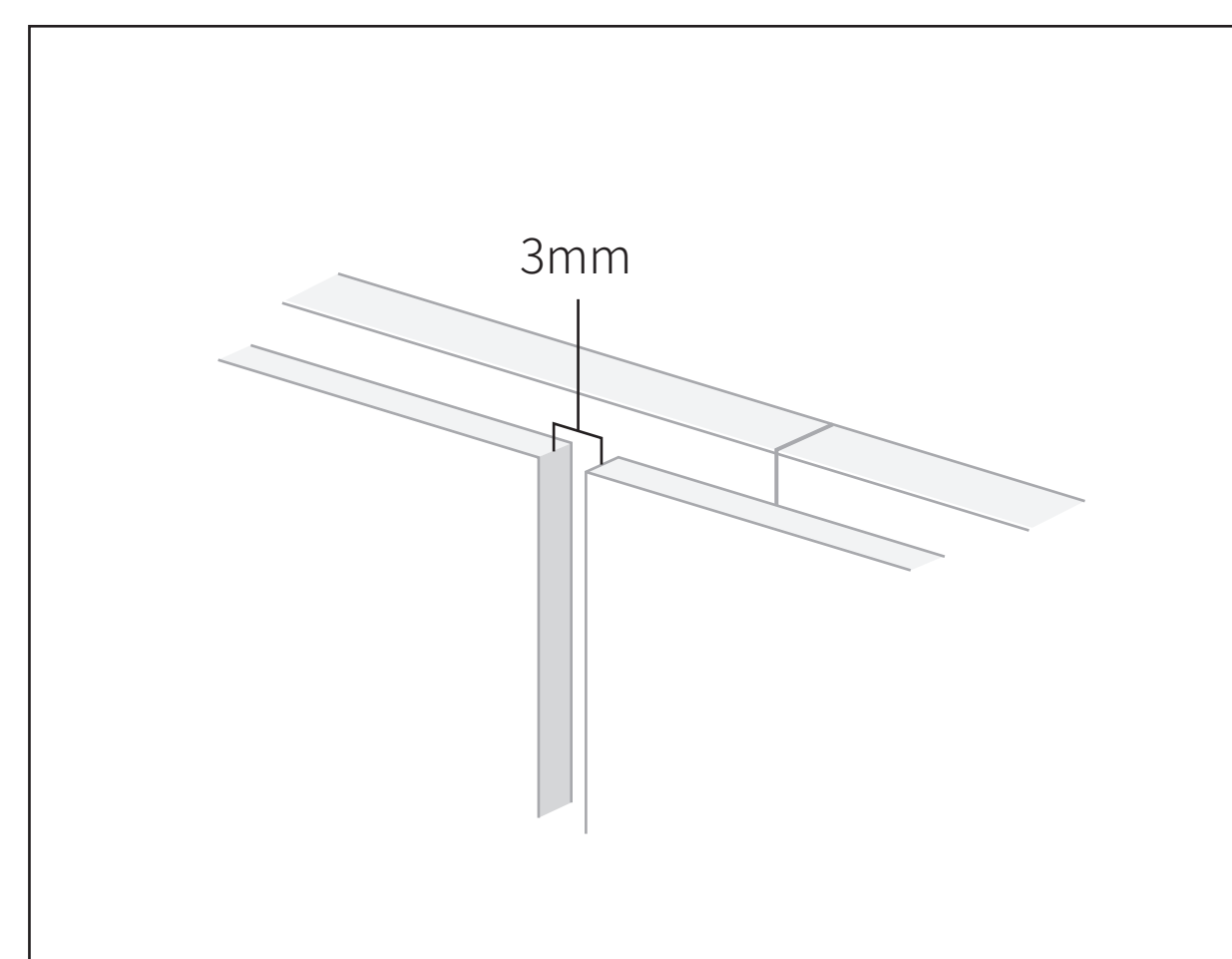

Joint of substrate & Joint of wall panel should be layout in different position. If wall panels applied without gap between, it could be delaminated by expansion. The gap should be more than 3mm.

3 Cutting and processing

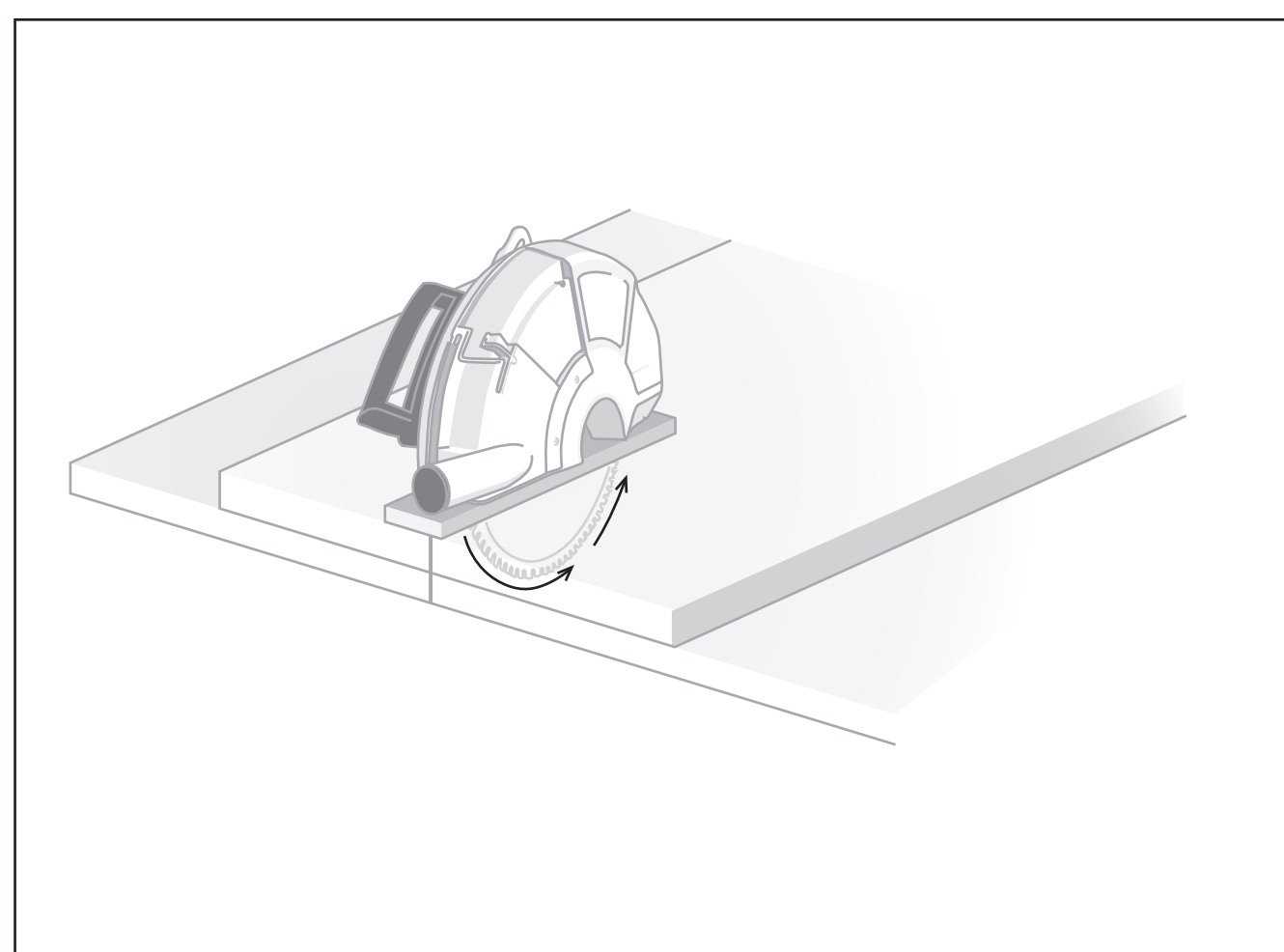

Use splint in order to keep the cutting edge clean. Cutter should start from face of the material and end from the back. (Face has protection film on the surface)

4 Double-sided tape application

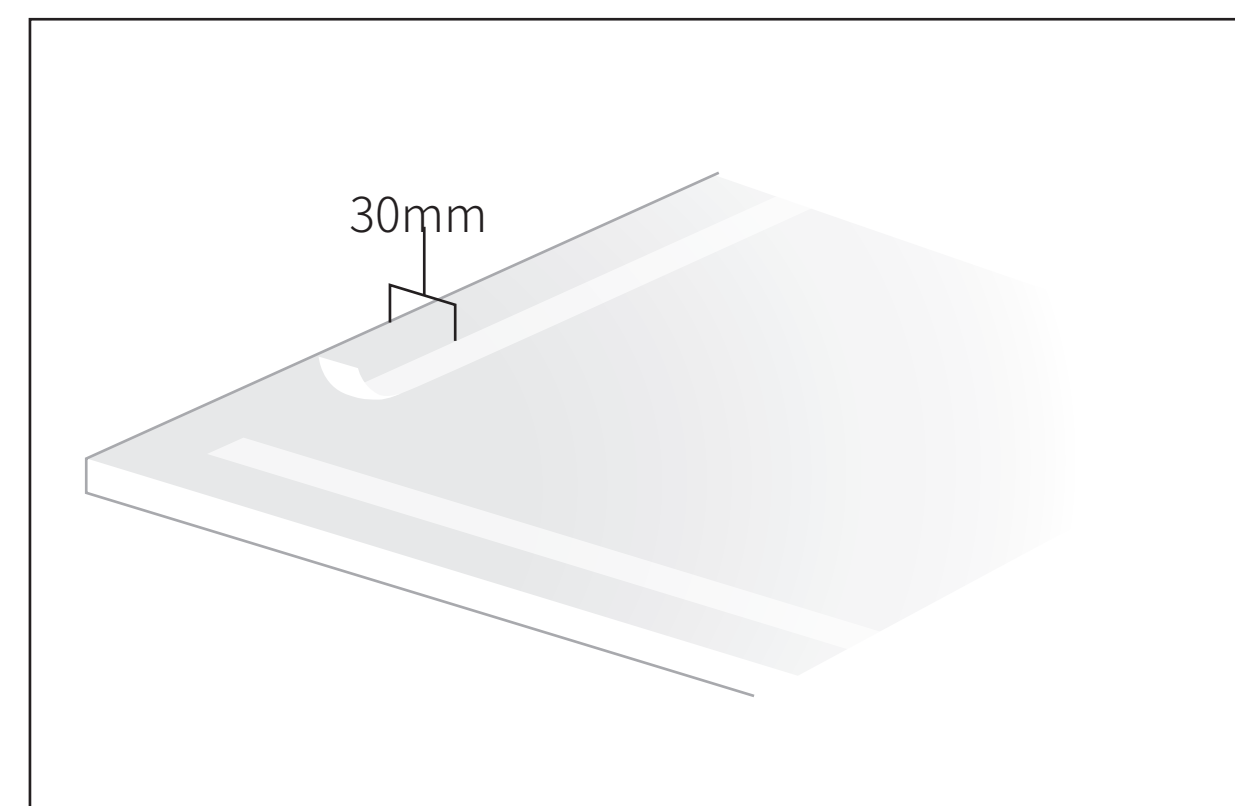

Apply double-sided tape away 300mm from edge of the panel (it gives temporary fix until adhesive fix completely)

Recommended tape:
Similar tape to 3M VMB #5952

5 Adhesive application

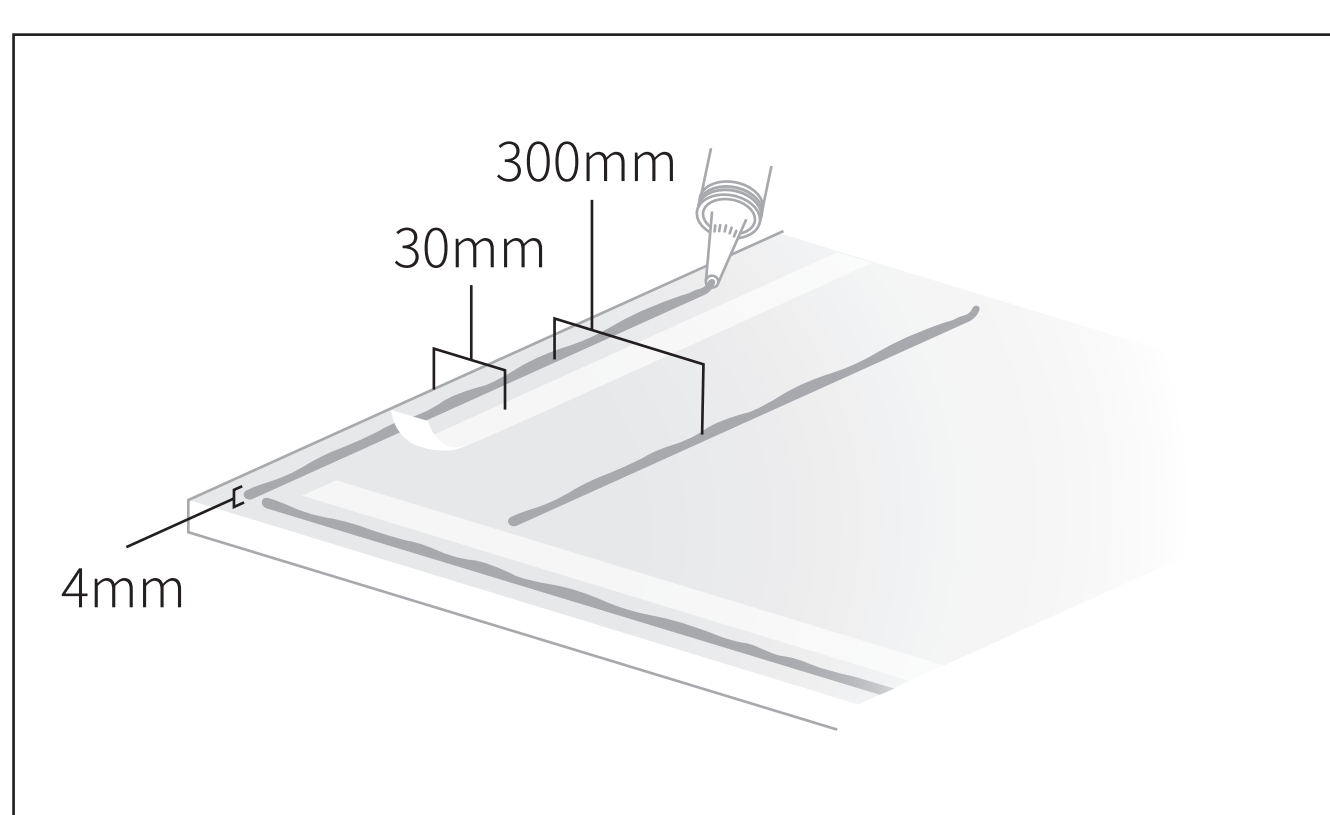

Don't forget applying adhesive on edges. Otherwise, it could be delaminated. Adhesive is in 4mm height, each adhesive should be within 300mm each other. The panel should be applied to substrate within 10 mins after adhesive application.

Recommended adhesive:
structural caulking
(Similar to Dow Corning 759)

6 Wall panel application & press

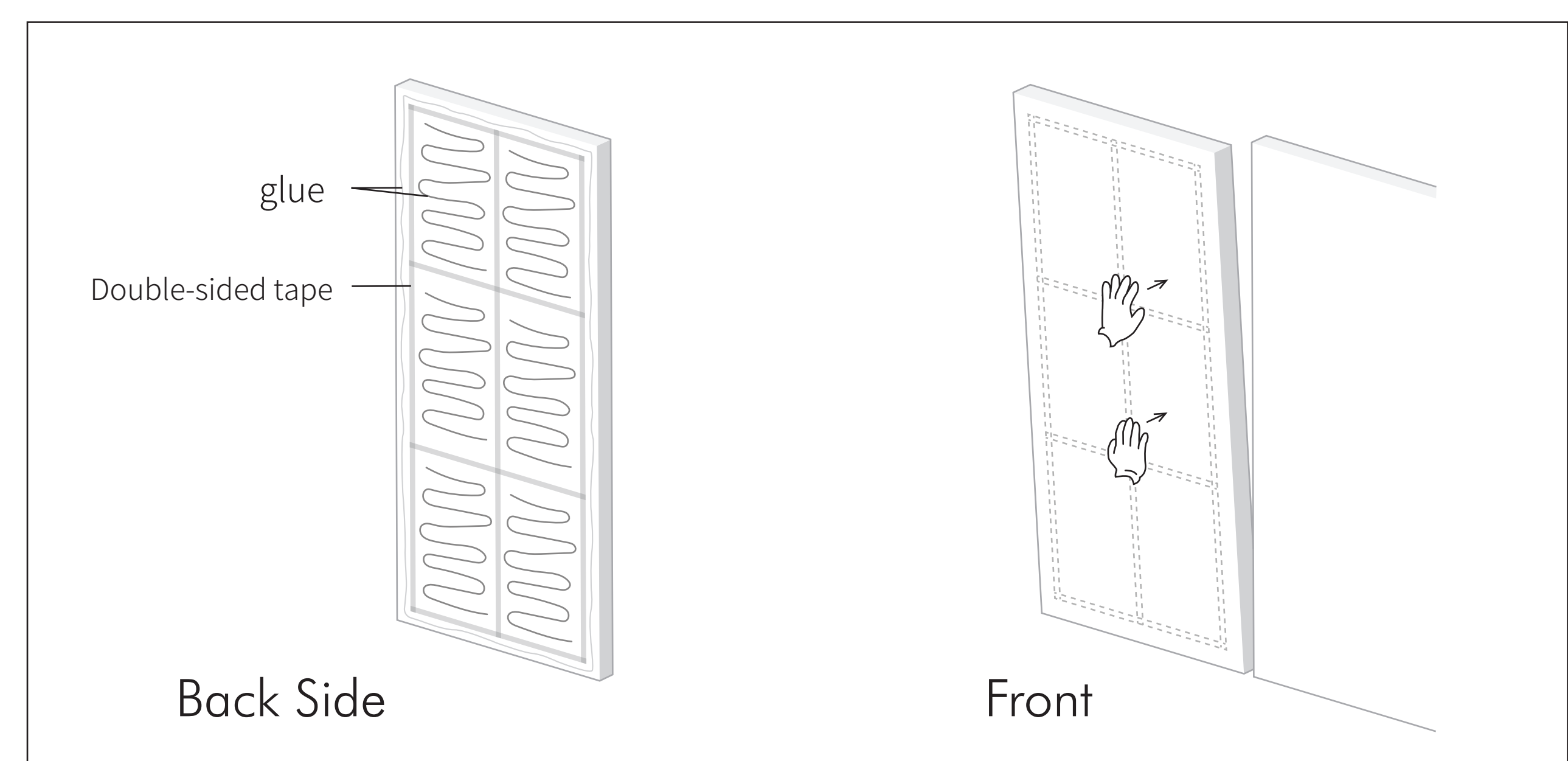

During application, make sure the center of the panel is completely applied to substrate (Double-sided tape is not adjustable after applying)

When pressing, press where double-sided tape are applied. (Pressing adhesive would make them squeeze out of the panel)

7 Protection film removal

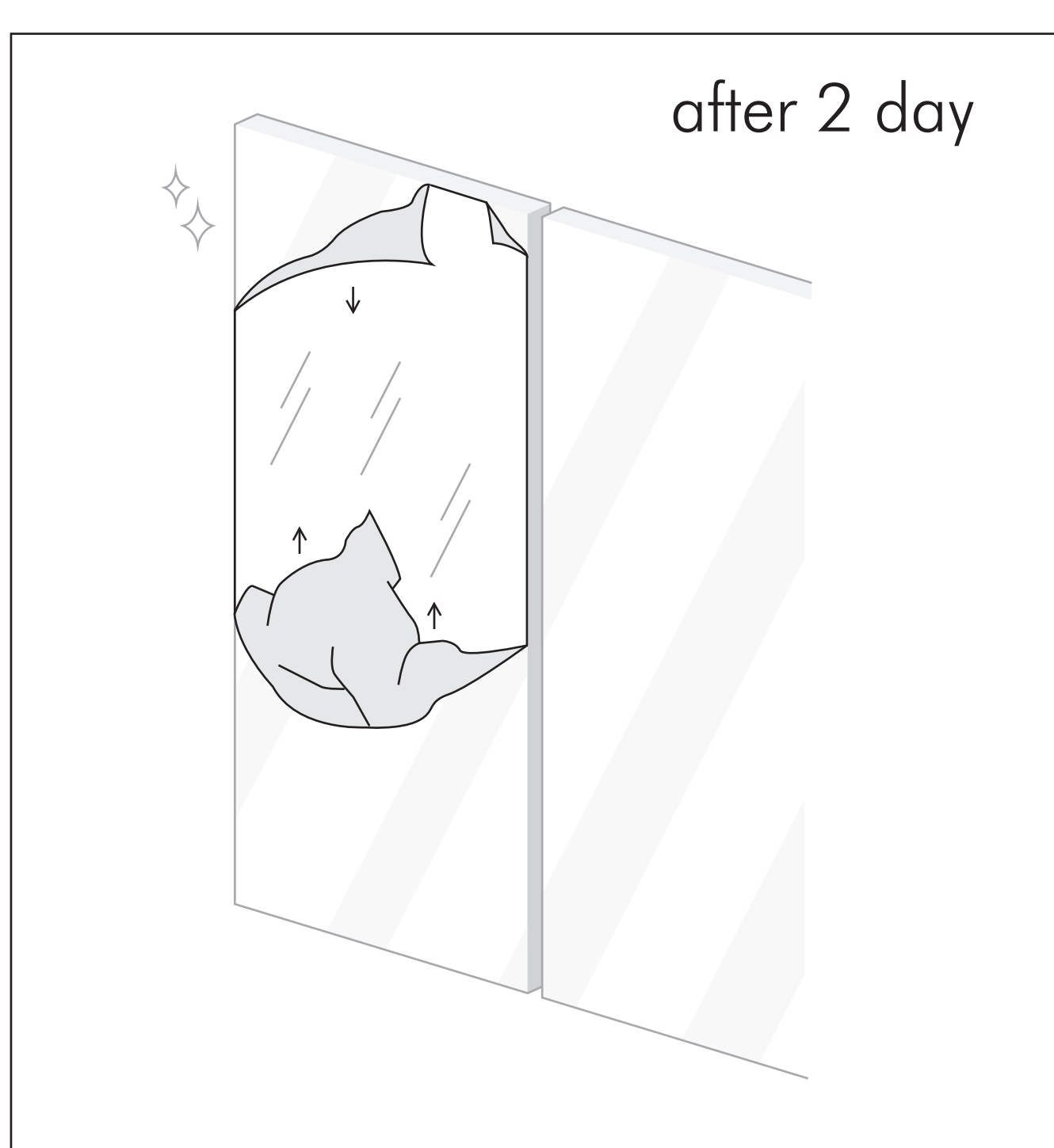

Remove protection film after 2 days from panel application. Pull the film slowly into center direction of the panel.

Product Information

1,200 x 2,400 x 3T
1,200 x 3,000 x 3T
1,200 x 3,600 x 3T

MELATONE Ltd.

MELATONE LTD (Headquarters)
54, Namdong dae-ro 153-gil, Gangnam-gu, Seoul, South Korea
T/ +82 32 723 7712 (7753)